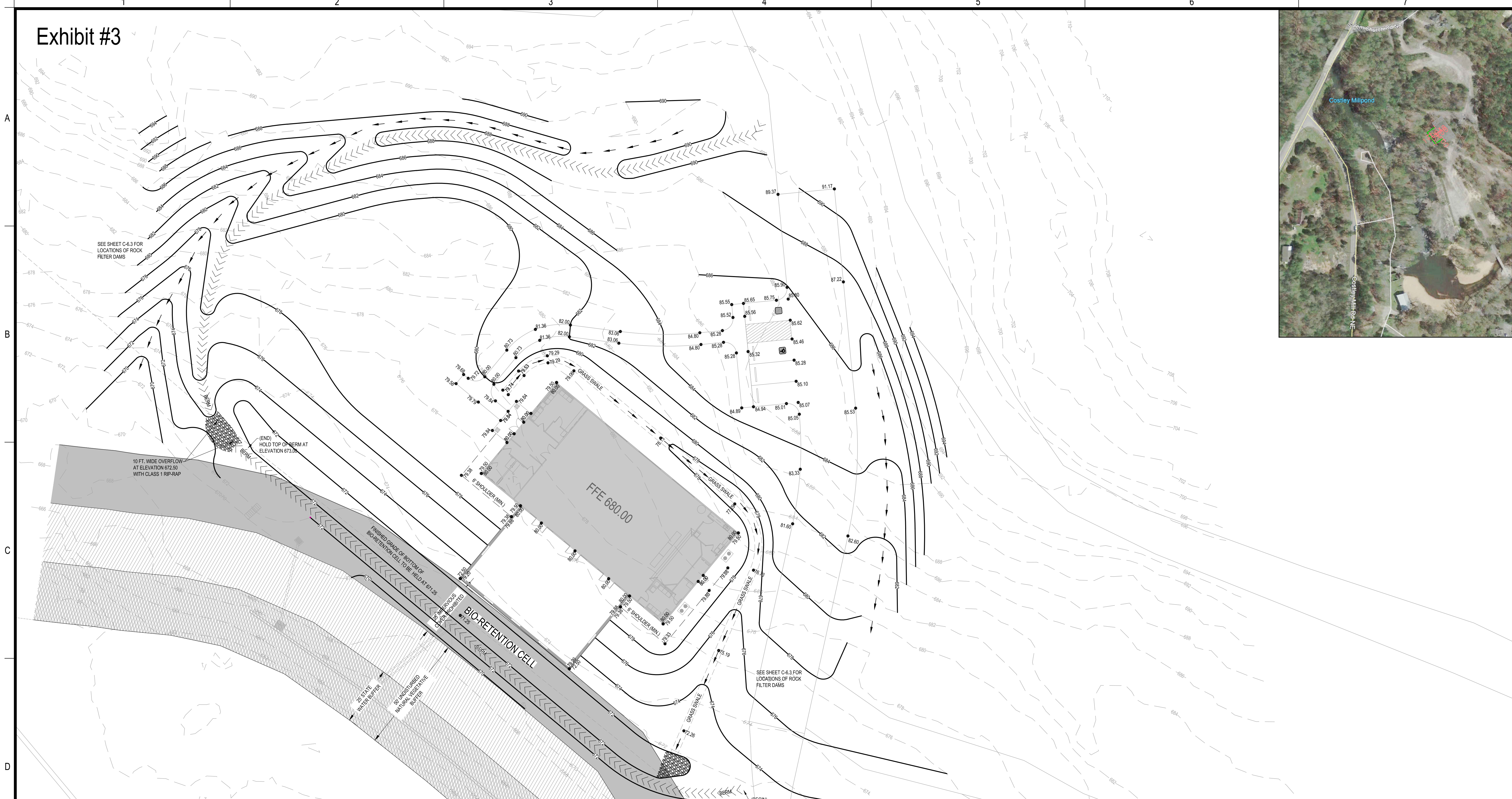

Exhibit #3



gc
georgia civil
 CIVIL ENGINEERING
 LANDSCAPE ARCHITECTURE
 LAND SURVEYING
 113 West Jefferson Street, Suite A
 P.O. Box 896 | Madison, GA 30650
 P: 706.342.1104 | F: 706.342.1105
 www.georgiacivil.com



Project Information

COSTLEY MILL EVENTS BUILDING
 PIN: 085002009A AND 085002008; LAND LOT 391 OF THE 16 DISTRICT
 2455 COSTLEY MILL ROAD, NE
 ROCKDALE COUNTY
 ZONING (COUNTY) - WP

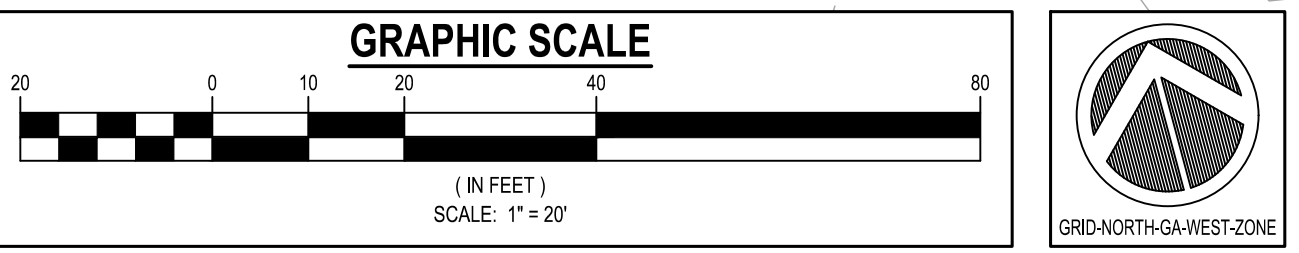

PROFILE IS SOLELY TO SHOW THE GRADES ALONG THE TOP BACK OF THE WALL AND ALONG THE FRONT FACE OF THE WALL. THESE PROFILES DO NOT SHOW ANY FOOTINGS OR OTHER STRUCTURAL REQUIREMENTS OF THE WALL.

THE OWNER IS RESPONSIBLE FOR HIRING A STRUCTURAL ENGINEER TO PERFORM ALL STRUCTURAL WALL DESIGNS INCLUDING THE WALL, FENCE, FOOTINGS, MATERIALS, DRAINAGE TILES, INSTALLATION PROCEDURES AND ANY OTHER STRUCTURAL COMPONENTS OF THE WALL DESIGN.

STRUCTURAL ENGINEER SHALL CONSULT WITH CIVIL ENGINEER FOR CONNECTING WALL DRAINAGE SYSTEM TO STORM COLLECTION SYSTEM (IF ANY) AND FOR COORDINATING REQUIRED LENGTHS AND LOCATIONS FOR GEORGRIDS. IF THE WALLS ARE TO BE MODULAR BLOCK WALLS.

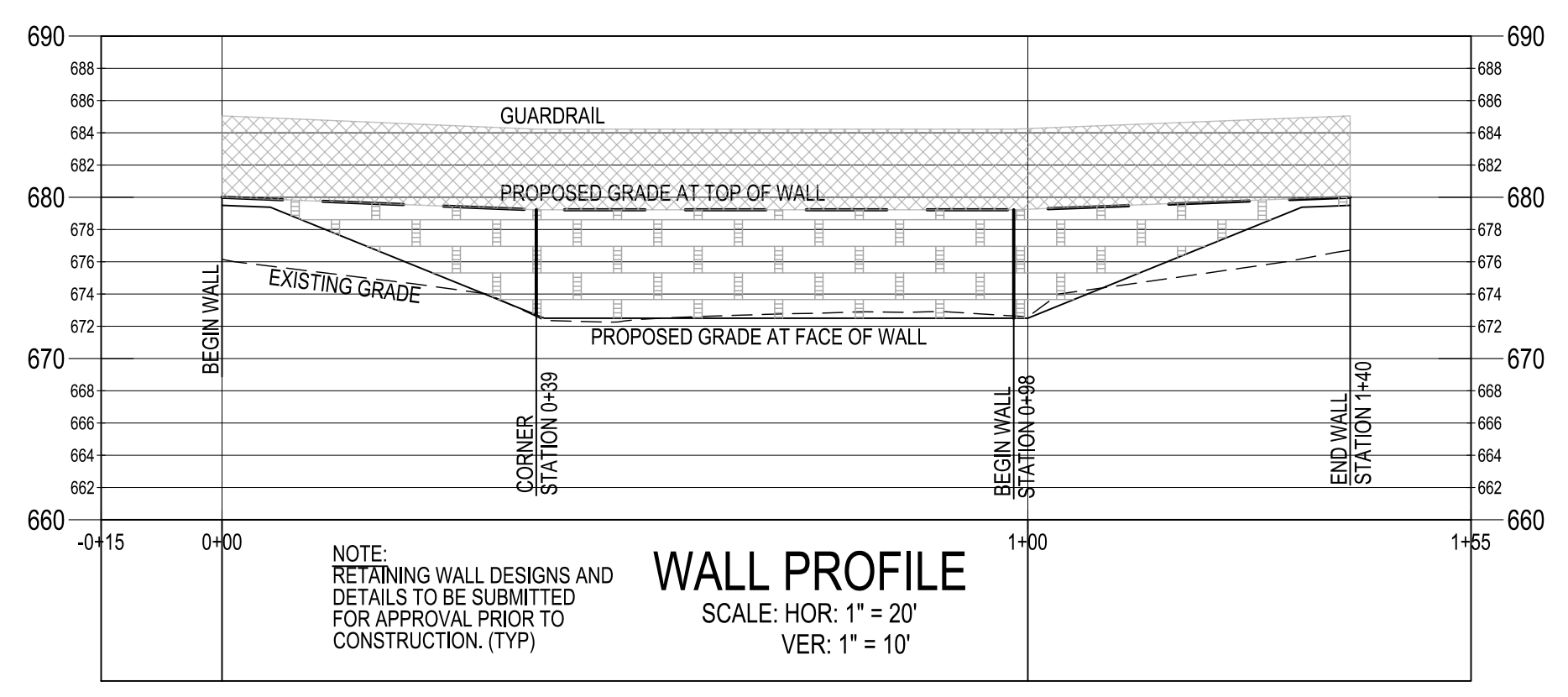

<p>OWNER/DEVELOPER NAME: ROCKDALE COUNTY B.O.C. ADDRESS: P.O. BOX 289 CONYERS, GA 30012 CONTACT: ANDREW HAMMER PHONE: 770-278-7268</p> <p>EMAIL: andrew.hammer@rockdalecountyga.gov</p> <p>CONTRACTOR NAME: TBD ADDRESS: TBD CONTACT: TBD PHONE: TBD</p> <p>EMAIL: tbd</p> <p>SURVEYOR NAME: GEORGIA CIVIL, INC. ADDRESS: P.O. BOX 896 MADISON, GA 30650 CONTACT: G. BRIAN SLATE PHONE: 706-342-1104 FAX: EMAIL: bslate@georgiacivil.com</p> <p>SITE DESIGNER NAME: GEORGIA CIVIL, INC. ADDRESS: P.O. BOX 896 MADISON, GA 30650 PHONE: 706-342-1104</p>	<p>JASON P. BROWN LEVEL II CERTIFIED DESIGN PROFESSIONAL #52374 - EXP. 5-1-2020</p> <p>24-HOUR CONTACT ANDREW HAMMER 770-278-7268</p> <p>GEORGIA811 Utilities Protection Center, Inc. Know what's below. Call before you dig.</p> <p>Unless/Services shown are for Contractor's convenience, items are shown schematically and neither the site design professional nor the owner assumes any responsibility for utilities in their actual location. This plan may not show and/or may incorrectly show utilities located on site. Contractor shall be responsible to locate and use the services of a private utility locator firm during the entire course of work and shall pay for said services. Contractor shall locate utilities prior to any disturbance (including field verifying location and depth of utilities that are to be saved and protected). Contractor shall notify the site design professional of any utility conflicts prior to installation of new utilities, grading, etc. The Contractor, at their expense, shall be responsible to repair, replace and/or relocate, as necessary, any utilities damaged, whether shown or not. Abandonment, relocation, etc. of utilities shall be coordinated with the respective utility company.</p>
---	---

DRAWING DATE:	4/2/18
DRAWN BY:	CMP
CHECKED BY:	JPB
REVISIONS	
DATE:	DESCRIPTION:
10-19-18	COUNTY COMMENTS

© Copyright 2018 georgia civil, inc.
 This document and its reproduction are the property of Georgia Civil, Inc. and may not be reproduced, published, or used in whole or in part without the written consent of Georgia Civil, Inc.

SITE GRADING PLAN

Sheet Number
C-3.1