

THIS MAP HAS BEEN COMPILED FROM THE MOST AUTHENTIC INFORMATION AVAILABLE, AND NEITHER ROCKDALE COUNTY NOR HERRICUTT AND ASSOCIATES, INC. ASSUME RESPONSIBILITY FOR ERRORS OR OMISSIONS.

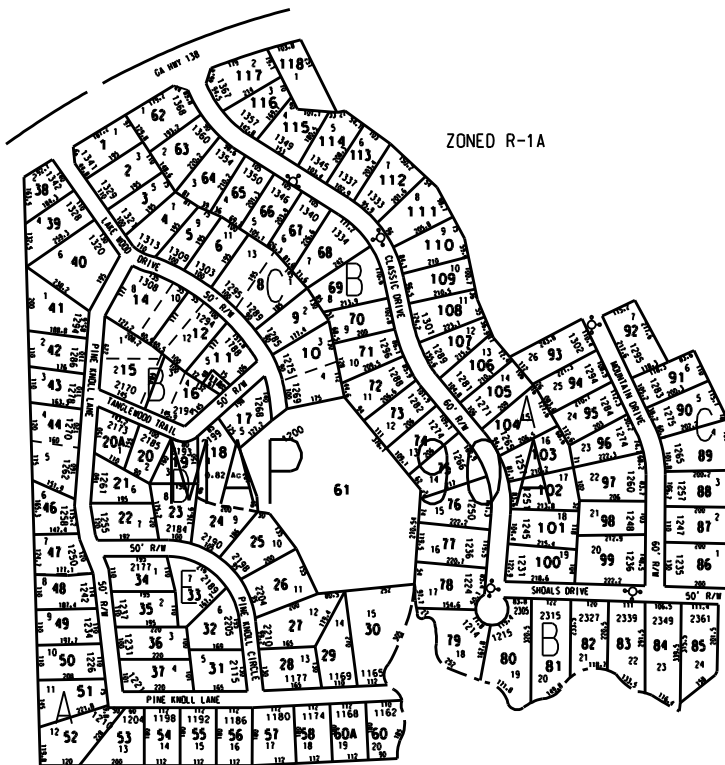

MOUNTAIN VALLEY ESTATES SECTION 1 (PAR 1 - 7, 12 - 14, 38 - 40)
 MOUNTAIN VALLEY ESTATES SECTION 2 (PAR 8 - 10, 15 - 20, 41 - 44 LOT 4)
 MOUNTAIN VALLEY ESTATES SECTION 3 (PAR 44 LOT 5 - 54, 21, 22, 34 - 37)
 MOUNTAIN VALLEY ESTATES SECTION 4 (PAR 23 - 33, 55 - 60)
 MOUNTAIN VALLEY ESTATES PHASE 1 (PAR 62 - 118)

LEGEND

- County Boundary
 - Map Boundary
 - Limit of Ownership
 - Original Platted Line
 - District Line
 - Railroad Right of Way
 - City Limit
 - Easement
 - Stream
- CHURCH SCHOOL CEMETERY

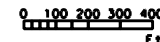

TAX VALUATION MAP	LAND LOT 341_342	MAP NO.
ROCKDALE COUNTY	DISTRICT 16	90A
GEORGIA		
DATE DEC. 1, 1987 LAST REVISION 1994	PHOTO NO.	