

THIS MAP HAS BEEN COMPILED FROM THE MOST AUTHENTIC INFORMATION AVAILABLE, AND NEITHER ROCKDALE COUNTY NOR HUNNICUTT AND ASSOCIATES, INC., ASSUME RESPONSIBILITY FOR ERRORS OR OMISSIONS

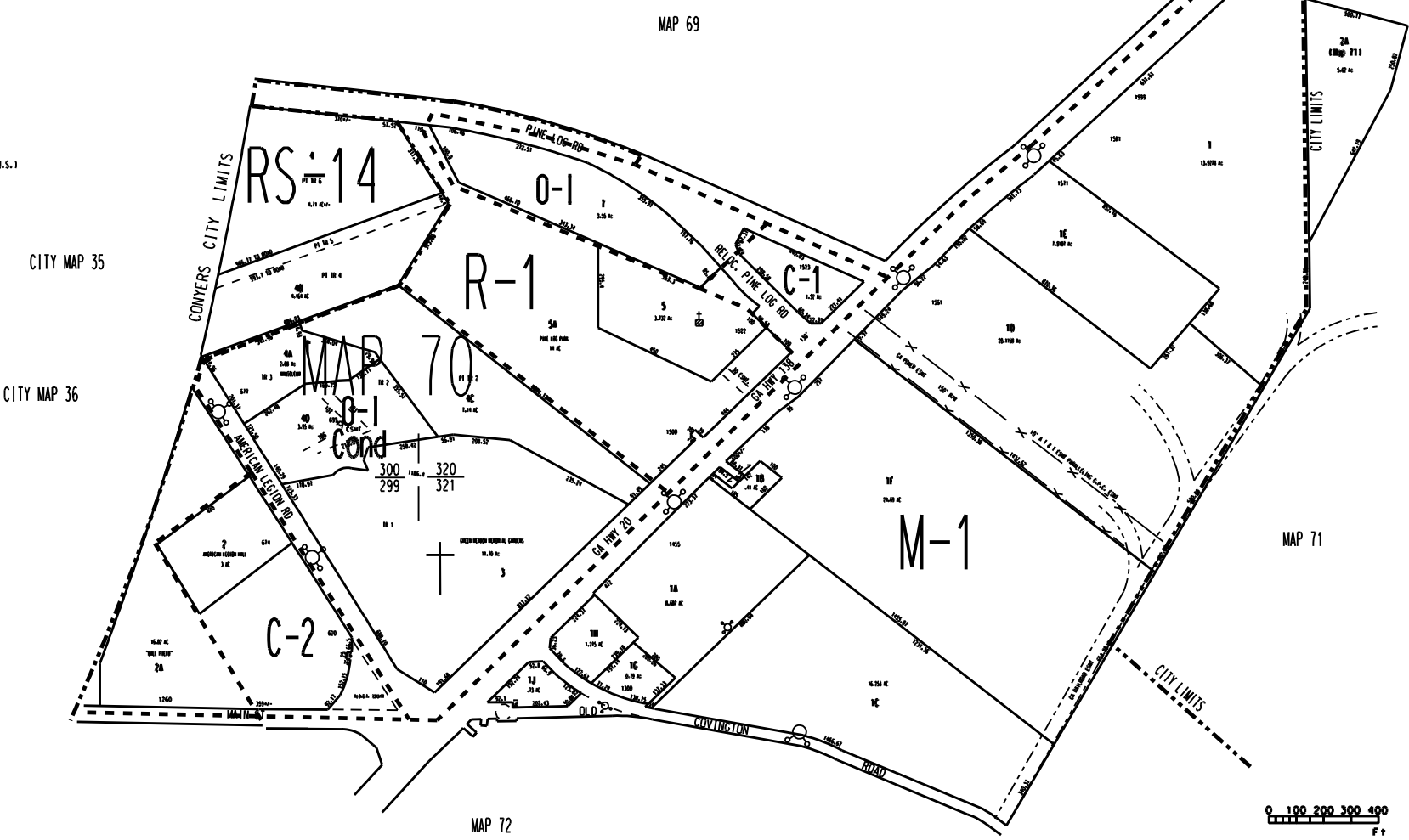

- NOTES:
1. PARCEL 70-1-1J OUT OF 70-1-1A FOR 2001 1910/16 9-8-00 (10-26-00 U.S.)
  2. 0.623 ac from 70-1-2A to D.O.T., deed 2343/77 6/11/02
  3. 2.002 ac from 70-1-7 to D.O.T., deed 2618/71 5/2/03
  4. 0.069 ac from 70-1-1E to D.O.T. 2995/226 5/20/03
  5. 0.021 ac from 70-1-5A to D.O.T. 2998/61 4/30/98
  6. 70-1-4D from 70-1-4C deed 3392/178 2/25/05
  7. 0.039 AC FROM 70-1-1 TO 71-1-3 BY DEED 3426/104



**LEGEND**

- Zoning: [Symbol]
- County Boundary: [Symbol]
- Map Boundary: [Symbol]
- Limit of Ownership: [Symbol]
- Original Platred Line: [Symbol]
- District Line: [Symbol]
- Right-of-Way: [Symbol]
- City Limits: [Symbol]
- Stream: [Symbol]

CHURCH [Symbol] SCHOOL [Symbol] CEMETERY [Symbol]

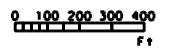

TAX VALUATION MAP	Lot 299-300	MAP NO.
ROCKDALE COUNTY	300-321	70
GEORGIA	DISTRICT 16	
	0-Map 43	
	0-Map 43	