



THIS MAP HAS BEEN COMPILED FROM THE MOST AUTHENTIC INFORMATION AVAILABLE, AND NEITHER ROCKDALE COUNTY NOR HURRICUT AND ASSOCIATES, INC. ASSUME RESPONSIBILITY FOR ERRORS OR OMISSIONS

NOTES:

1. PARCEL 63-18-38 SPLIT PER DEED 1363/354 5/19/97 REINSTATED PARCEL 63-18-40 (LOT 3941 FOR 98, US
2. PARCELS 63-18-29 & 63-18-28 COMBINED WITH 63-18-30 FOR 1998 PER OWNER. (US: 4-22-98)
3. PARCELS 63-8-8A OUT OF 63-8-8 FOR 2002 PER DEED 2037/1 5-10-01 (US: 7-5-01)
4. PARCEL 63-17-8 SPLIT PER DEEDS 2042/21-22-23-24 7/5/01 REINSTATED PARCELS 63-17-6, 7 & 9 (LOTS 536, 537 & 539) FOR 2002 (US 7-5-01)
5. 63-23-6 combined w/ 63-23-7 for 02 by owners request
6. 63-11-4, 63-11-19, & 63-11-20 combined with 63-11-5 by owners request
7. 63-29-51 from 63-29-106 deed 2364/704 7/11/02
8. 63-14-33 combined w/ 63-14-32 for 03 by plat 31/119
9. 63-1-26 combined with 63-2-25 by plat 32/30, for 04 for tax year
10. 63-23-4 combined with 63-23-5 by plat 32, 7 04 for 04 tax year
11. 63-26-8 from 63-26-7 deed 3085/214 1/23/04
12. 63-17-11 combined with 63-17-13 by owners request 2004
13. 63-26-11 combined w/63-26-16 2006

MAP 54

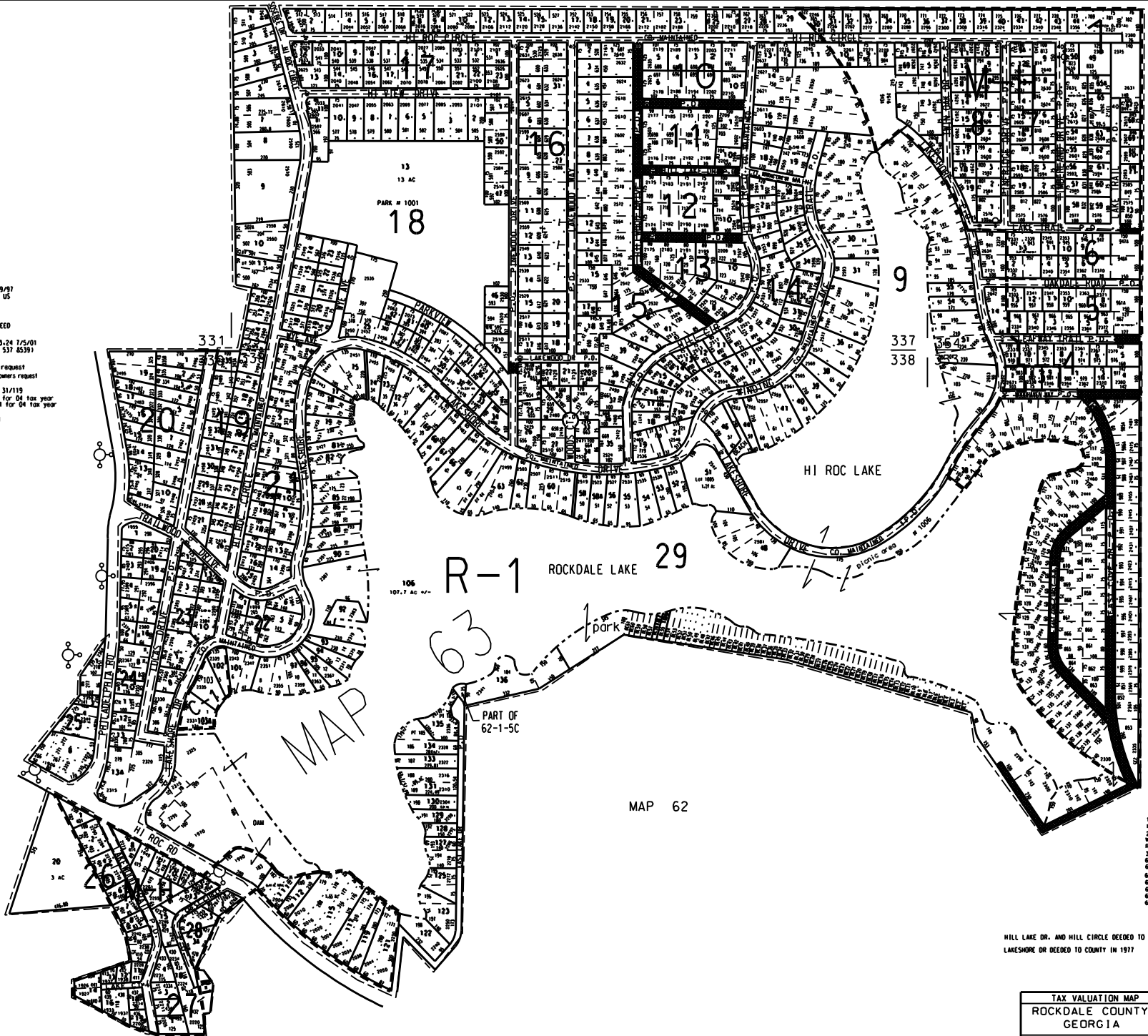

LEGEND

- County Boundary
 - Map Boundary
 - Limit of Ownership
 - Original Platted Line
 - District Line
 - Railroad Right of Way
 - City Limit
 - Coverment
 - Stream
- CHURCH SCHOOL CEMETERY

NOTES:

1. HATCHED AREAS DENOTE ROADS NOT ACCESSIBLE OR NOT THERE - 98
2. PARCEL 63-18-43 COMBINED WITH 63-18-1 FOR 2002 PER OWNER'S REQUEST (US 7-4-02)
3. PARCEL 63-29-106 COMBINED WITH 63-2-1, 63-9-48, 63-8-65, 63-29-1, 63-29-38, 63-29-109, 63-29-138, 63-29-143, 63-29-144, 63-29-145, 63-29-146, 63-29-147, 63-29-163, 63-29-164, 63-29-179, 63-29-180, 63-29-181, 63-29-182, 63-29-183, 63-29-188, 63-30-1.

HILL LAKE DR. AND HILL CIRCLE DECEDED TO COUNTY 8/22/89 DEED 500/114
LAKESHORE DR DECEDED TO COUNTY IN 1977

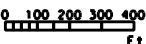

TAX VALUATION MAP	LAND LOT 330, 327	MAP NO.
ROCKDALE COUNTY	330, 353, 354	63
GEORGIA	DISTRICT 16	
	C. M. O. 475	
DATE DEC. 1, 1987	LIST REVISION 2004	PHOTO NO. 138