

THIS MAP HAS BEEN COMPILED FROM THE MOST AUTHENTIC INFORMATION AVAILABLE, AND NEITHER ROCKDALE COUNTY NOR HUNNICUTT AND ASSOCIATES, INC. ASSUME RESPONSIBILITY FOR ERRORS OR OMISSIONS

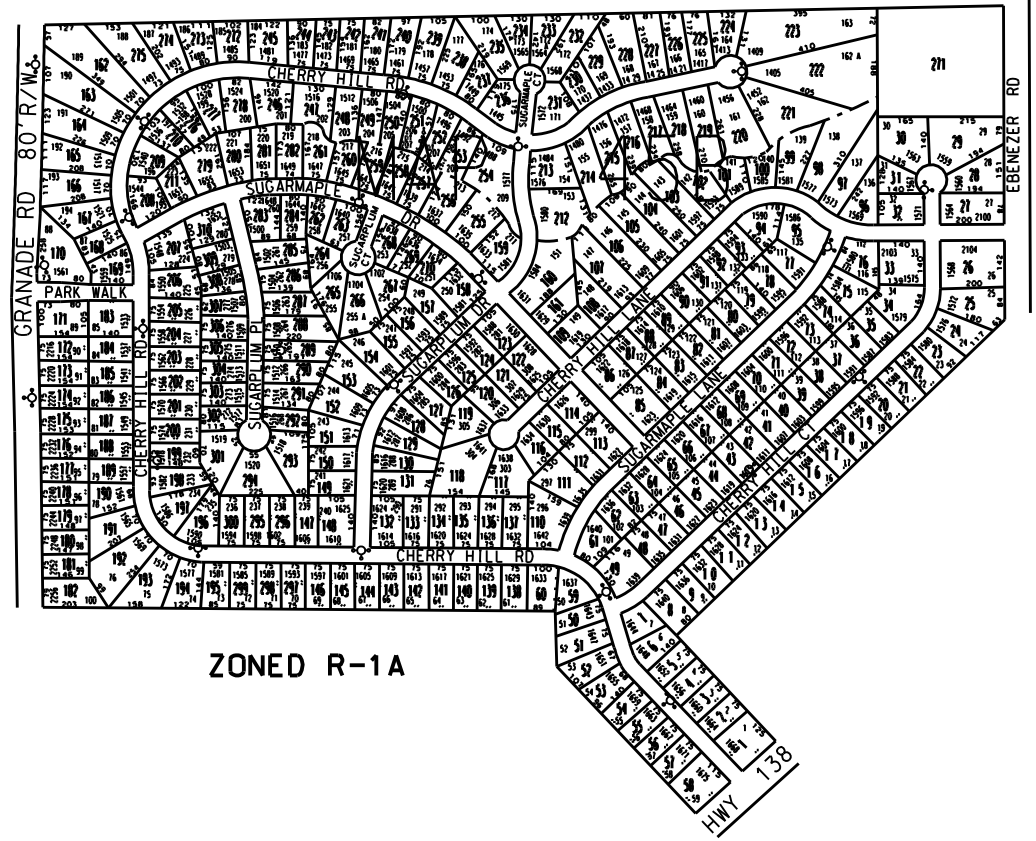

LEGEND

- County Boundary
  - Map Boundary
  - Limit of Ownership
  - Original Platted Line
  - District Line
  - Right of Way
  - City Limit
  - Easement
  - Stream
- 
- CHURCH SCHOOL CEMETERY

SUGER HILL UNIT 5 1988 (PAR 272 - 310)  
 PARKVIEW ESTATES (PAR 162 - 211)  
 SUGAR HILL UNIT 3 & 4 1986 (PAR 123 - 270)  
 SUGAR HILL UNIT 2 1985 (PAR 59 - 122)  
 SUGAR HILL UNIT 1 1984

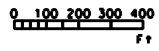

TAX VALUATION MAP	LAND LOT 209-240	MAP NO.
ROCKDALE COUNTY GEORGIA	DISTRICT 11	45B
DATE: DEC. 1, 1987 LAST REVISED: 1993	G. M. O.	1" = 200'